

Description

The FIRE KILL™ Low Pressure Water Mist Nozzle Model OH-OPX1 is a patented open, low pressure water mist nozzle which is ideal for installations on car and truck decks on ships, ferries, etc. The nozzle provides a highly reliable and enhanced firefighting performance along with low water requirements, which is typical for VID Fire-Kill water mist nozzles.

The nozzle comes in two versions:

Suez OH-OPX1 for vehicle decks up to 2.5m ceiling height and Panama OH-OPX1 for vehicle decks up to 5m ceiling height.



Approvals

The Suez and Panama OH-OPX1 nozzle has been tested in accordance with IMO Resolution MSC.1/Circ. 1430 for RORO spaces and special category spaces and MED-B, UK MER-B and TA approved by DNV. The OH-OPX1 can therefore be used for securing storage rooms, car decks, truck decks and other similar areas.



Technical data

General description		
Minimum water pressure	6 bar	
Maximum working pressure	16 bar	
K-factor (metric)	23 (l/min@1 bar)	
Drop size	DV ₉₀ < 300 µm	
Application		
Model Suez OH-OPX1	Coverage Area	16 m ² (4m x 4m)
	Distance to wall	Max 2 m
	Max Ceiling Height	2.5m
Model Panama OH-OPX1	Coverage Area	12.25 m ² (3.5m x 3.5m)
	Distance to wall	Max 1.75m
	Max Ceiling Height	5m
Specific description		
Weight	0.15 kg	
Housing material	AISI 316	
Coating	Natural	
Strainer	Stainless Steel	
Thread	½" BSP/ BSP-T / NPT	
Hydraulic system		
Water density	3.52-4.60 mm/m ²	
Design area and system operation time	According to AHJ	

Dimension

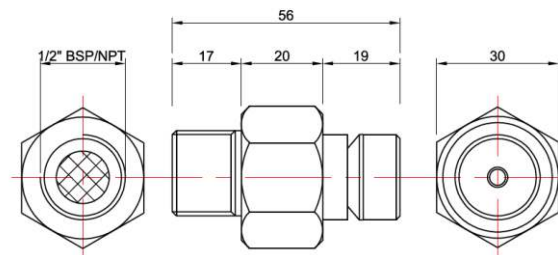

Installation

The Suez OH-OPX1 nozzles are installed pendent at the ceiling with a maximum distance of 4 m between nozzles and a maximum distance of 2 m to any walls for areas with ceiling heights up to 2,5m. The Panama OH-OPX1 nozzles are installed with a maximum distance of 3.5 m between nozzles and a maximum distance of 1.75m to any walls for areas with ceiling heights from 2.5m to 5m.

The Suez and Panama OH-OPX1 nozzles should only be installed in clean, non-corrosive pipe systems, which do not cause galvanic corrosion to the nozzle, system components or pipe hangers, and with clean rinsed internal surfaces free of impurities. The water quality should be free of chlorides and impurities. The system should be in materials found acceptable by the authorities having jurisdiction. Design criteria following MSC.1/Circ. 1430:

"3.1 The system may be automatically activated, manually activated or automatically activated with manual release capabilities. Automatic activation should be approved by the Administration, taking into account the implications of such activations."

Spray Patterns

Diagrams illustrating the spray patterns of OH-OPX1 Suez and OH-OPX1 Panama are shown on the right side.

OH-OPX1 Suez & Panama Spray Patterns

Suez OH-OPX1 Nozzle Installation in ceiling heights up to 2.5m:

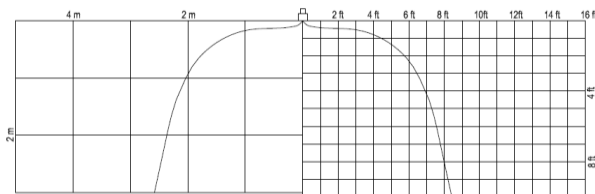

Panama OH-OPX1 Nozzle Installation in ceiling heights up to 5m:

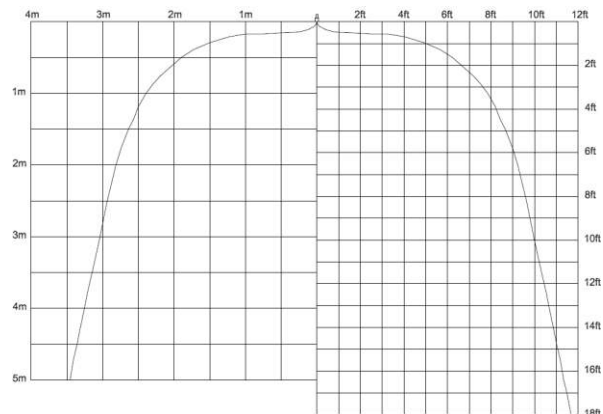

Contact

For further information on FIRE KILL™ products, please contact our sales department at Sales@vidfirekill.com

VID Fire-Kill APS is not responsible for any errors or omissions, or for the results obtained from the use of this information. All information in this document is provided "as is", with no guarantee of completeness, accuracy, functionality, timeliness or of the results obtained from the use of this information.